

ELECTRIC WINDLASS

➤ *KDJ Series*

KDJ-300

KDJ-500 ,KDJ-1000

Model	Load rated (kg)	Speed (m/min)	Motor (hp x p)	Voltage (v)	Frequency (Hz)	Lifting Height (m)	Steel cable (φ mm x m)	N.W. (kg)	Percentage duty cycle
LKDJ300	300	10-15	1.5X4	3-phase 380v 415v	50	29	7X30	48	25% ED (150 times/h max. starting frequency)
LKDJ500	500	12-18	3.0X4		50	58	9X60	136	
LKDJ1	1000	12-18	5.5X4		50	58	11X60	156	
LKDJ2.2	2200	7-12.5	7.5X4		50	97	16X100	450	
LKDJ3.2	3200	6.3-8.8	7.5X6		50	97	18X100	500	

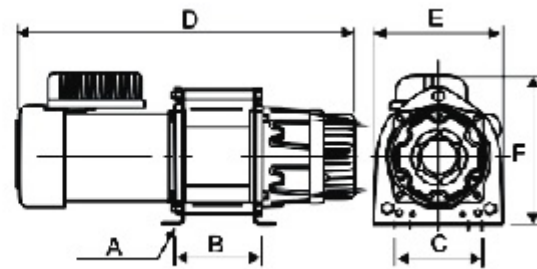
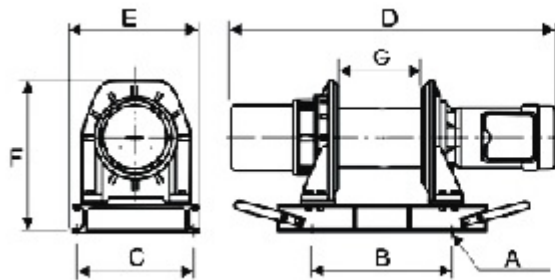

Symbol 符号	LKDJ300	LKDJ500	LKDJ1
A(mm)	4-φ 10.5	4-φ 16	4-φ 15
B(mm)	172	400	400
C(mm)	142	330	300
D(mm)	548	922	935
E(mm)	210	372	372
F(mm)	246	430	430